

Soils Map

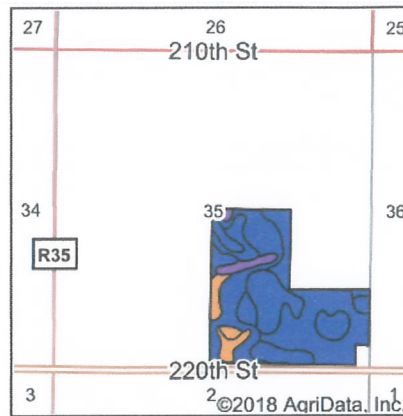

State: **Iowa**
 County: **Wright**
 Location: **35-92N-25W**
 Township: **Lake**
 Acres: **112.91**
 Date: **12/16/2018**

Maps Provided By:

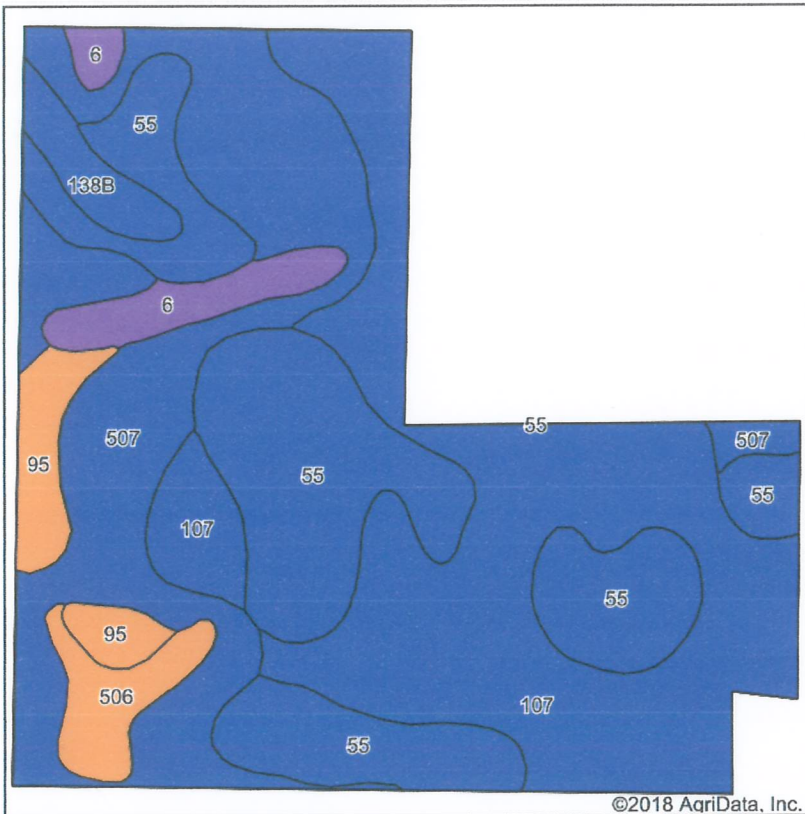

Soils data provided by USDA and NRCS.

Area Symbol: IA197, Soil Area Version: 25

Code	Soil Description	Acres	Percent of field	CSR2 Legend	Non-Irr Class *c	CSR2**	CSR	*n NCCPI Soybeans
107	Webster clay loam, 0 to 2 percent slopes	39.39	34.9%		Ilw	86	83	80
55	Nicollet clay loam, 1 to 3 percent slopes	30.67	27.2%		Iw	89	88	78
507	Canisteo clay loam, 0 to 2 percent slopes	28.55	25.3%		Ilw	84	78	79
95	Harpis clay loam, 0 to 2 percent slopes	4.20	3.7%		Ilw	72	62	77
6	Okoboji silty clay loam, 0 to 1 percent slopes	4.09	3.6%		Illw	59	57	77
506	Wacousta silty clay loam, 0 to 1 percent slopes	3.38	3.0%		Illw	74	74	93
138B	Clarion loam, 2 to 6 percent slopes	2.63	2.3%		Ile	89	80	83
Weighted Average						84.5	81	*n 79.4

**IA has updated the CSR values for each county to CSR2.

*n: The aggregation method is "Weighted Average using major components"

*c: Using Capabilities Class Dominant Condition Aggregation Method

Soils data provided by USDA and NRCS.