

Soils Map

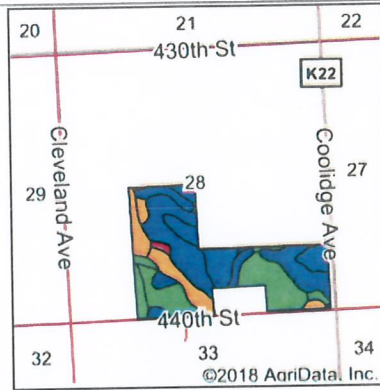
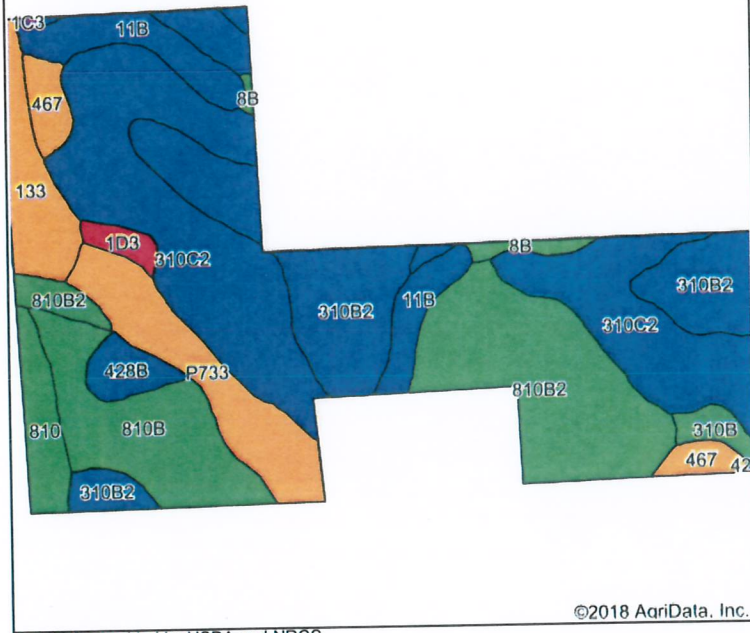

State: **Iowa**
 County: **Sioux**
 Location: **28-95N-47W**
 Township: **Eagle**
 Acres: **141.7**
 Date: **12/20/2018**

BEYER
 AUCTION & REALTY
 SIOUX CENTER, IA
 712-722-4315
 WWW.BEYERAUCTIONANDREALTY.COM

Maps Provided By:

surety
 CUSTOMIZED ONLINE MAPPING
 © AgriData, Inc. 2018 www.AgriDataInc.com



Soils data provided by USDA and NRCS.

Area Symbol: IA167, Soil Area Version: 28

Code	Soil Description	Acres	Percent of field	CSR2 Legend	Non-Irr Class *c	CSR2**	CSR	*n NCCPI Soybeans
310C2	Galva silty clay loam, 5 to 9 percent slopes, eroded	42.98	30.3%		Ille	84	51	61
310B2	Galva silty clay loam, 2 to 5 percent slopes, eroded	22.26	15.7%		Ile	90	65	62
810B2	Galva silty clay loam, terrace, 2 to 5 percent slopes, eroded	21.73	15.3%		Ile	92	63	59
810B	Galva silty clay loam, terrace, 2 to 5 percent slopes	13.25	9.4%		Ile	95	65	75
P733	Calco silty clay loam, 0 to 2 percent slopes, occasionally flooded	11.00	7.8%		Ilw	78		71
11B	Radford-Judson complex, 0 to 5 percent slopes	8.53	6.0%		Ilw	84	56	85
133	Colo silty clay loam, deep loess, 0 to 2 percent slopes, occasionally flooded	6.71	4.7%		Ilw	78	70	79
810	Galva silty clay loam, terrace, 0 to 2 percent slopes	4.25	3.0%		I	100	70	76
467	Radford silt loam, 0 to 2 percent slopes	3.76	2.7%		Ilw	79	73	91
428B	Ely silty clay loam, shallow loess, 2 to 5 percent slopes	2.80	2.0%		Ile	88	70	74
310B	Galva silty clay loam, 2 to 5 percent slopes	1.64	1.2%		Ile	95	67	74
1D3	Ida silt loam, 9 to 14 percent slopes, severely eroded	1.39	1.0%		Ille	32	35	47
8B	Judson silty clay loam, deep loess, 2 to 5 percent slopes	1.26	0.9%		Ile	92	69	78
1C3	Ida silt loam, 5 to 9 percent slopes, severely eroded	0.14	0.1%		Ille	58	44	49
Weighted Average						86.5	*	*n 66.9