

Soils Map

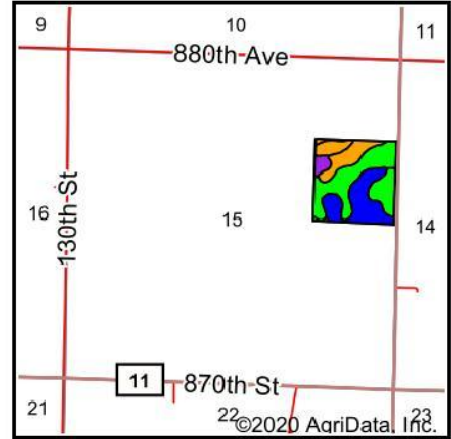

State: **Minnesota**
 County: **Renville**
 Location: **15-116N-38W**
 Township: **Wang**
 Acres: **39.73**
 Date: **8/24/2020**

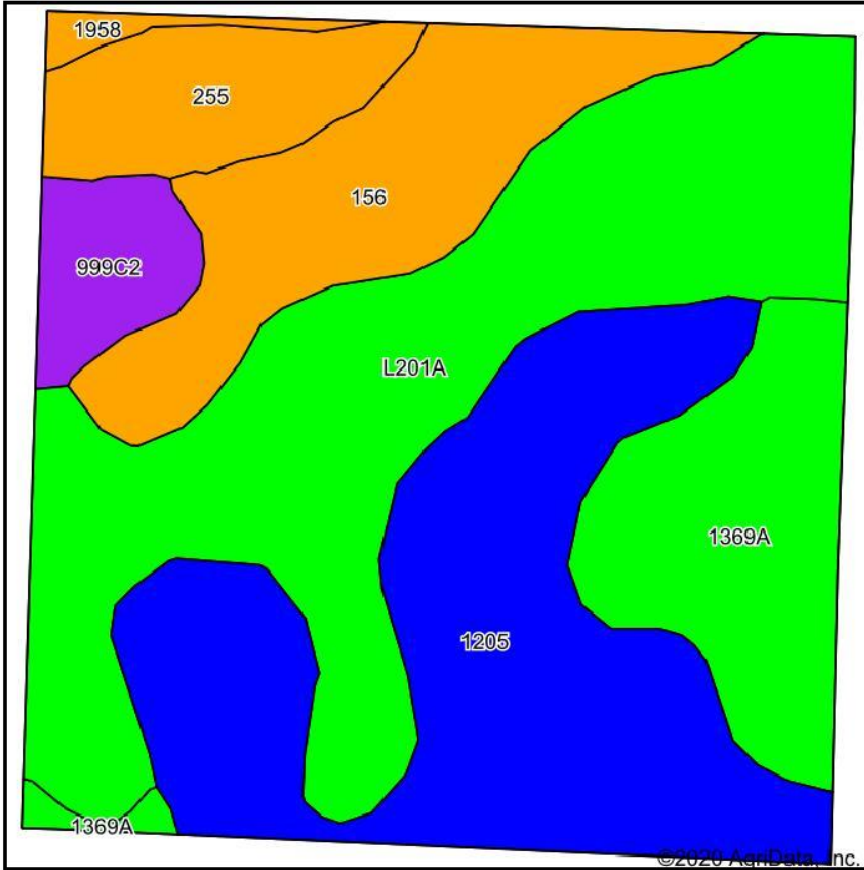

Soils data provided by USDA and NRCS.

Area Symbol: MN129, Soil Area Version: 17

Code	Soil Description	Acres	Percent of field	PI Legend	Non-Irr Class *c	Productivity Index	Bromegrass alfalfa	Bromegrass alfalfa hay	Cor n	Oats	Reed canarygrass	Soybeans	Spring wheat	Wheat	*n NCCPI Soybeans
L201A	Normania loam, 1 to 3 percent slopes	13.27	33.4%		le	99									85
1205	Leen-Okoboji, depressional, complex, 0 to 2 percent slopes	11.50	28.9%		llw	89	4.9	3.8	162	83	5.5	49	50		78
156	Fairhaven silt loam, 0 to 2 percent slopes	5.28	13.3%		lls	78	5.6	4.3	143	88		43	53		59
1369A	Crooksford silt loam, 1 to 3 percent slopes	5.17	13.0%		l	100	6.3	4.8	183	91		55	55		78
255	Mayer loam, 0 to 2 percent slopes	2.59	6.5%		llw	72									68
999C2	Ves-Storden-Hawick complex, 6 to 12 percent slopes, eroded	1.56	3.9%		llle	60	4.6	3.5	110	70		33		42	49
1958	Danube silty clay, 0 to 2 percent slopes	0.36	0.9%		llw	74	4.2	3.2	135	78		41	47		62
Weighted Average						89.9	3.2	2.5	95.3	51	1.6	28.7	29.1	1.6	*n 75.9

*n: The aggregation method is "Weighted Average using all components"

*c: Using Capabilities Class Dominant Condition Aggregation Method

Soils data provided by USDA and NRCS.