

Soils Map

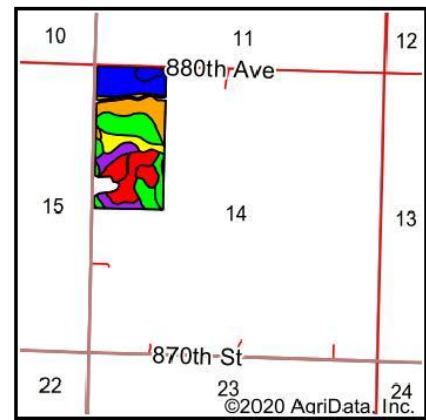

State: **Minnesota**
 County: **Renville**
 Location: **14-116N-38W**
 Township: **Wang**
 Acres: **73.46**
 Date: **8/24/2020**

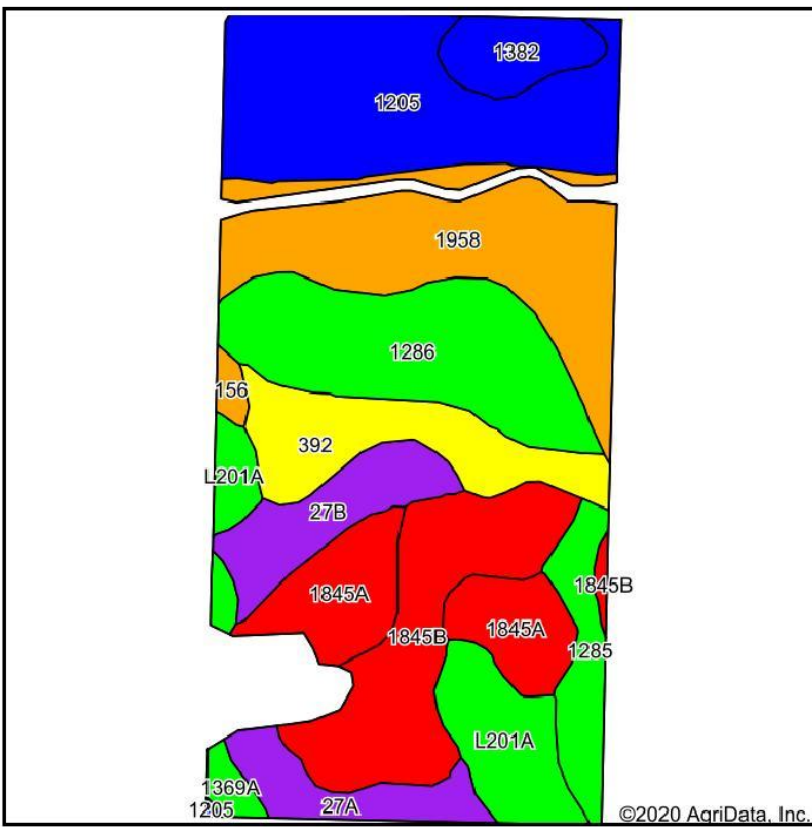

Soils data provided by USDA and NRCS.

©2020 AgriData, Inc.

| Area Symbol: MN129, Soil Area Version: 17 | | | | | | | | | | | | | | |
|---|--|-------|------------------|-----------|------------------|--------------------|--------------------|------------------------|--------------|-------------|------------------|-------------|--------------|-------------------|
| Code | Soil Description | Acres | Percent of field | PI Legend | Non-Irr Class *c | Productivity Index | Bromegrass alfalfa | Bromegrass alfalfa hay | Corn | Oats | Reed canarygrass | Soybeans | Spring wheat | *n NCCPI Soybeans |
| 1205 | Leen-Okoboji, depressional, complex, 0 to 2 percent slopes | 12.84 | 17.5% | | Ilw | 89 | 4.9 | 3.8 | 162 | 83 | 5.5 | 49 | 50 | 78 |
| 1958 | Danube silty clay, 0 to 2 percent slopes | 11.52 | 15.7% | | Ilw | 74 | 4.2 | 3.2 | 135 | 78 | | 41 | 47 | 62 |
| 1286 | Prinsburg silty clay loam, 0 to 2 percent slopes | 9.94 | 13.5% | | Ilw | 91 | 5.2 | 4 | 167 | 85 | | 50 | 51 | 87 |
| 1845B | Estherville sandy loam, 2 to 6 percent slopes | 8.64 | 11.8% | | Ills | 44 | | | | | | | | 37 |
| 1845A | Estherville loam, 0 to 2 percent slopes | 6.20 | 8.4% | | Ills | 44 | 2.9 | 2.2 | 81 | 60 | | 24 | 37 | 38 |
| 392 | Biscay clay loam, 0 to 2 percent slopes | 5.71 | 7.8% | | Ilw | 70 | | | | | | | | 66 |
| L201A | Normania loam, 1 to 3 percent slopes | 4.99 | 6.8% | | Ie | 99 | | | | | | | | 85 |
| 27B | Dickinson loam, 2 to 6 percent slopes | 3.86 | 5.3% | | Ills | 60 | 3.9 | 3 | 110 | 76 | | 33 | 46 | 44 |
| 1285 | Chetomba silty clay loam, 0 to 2 percent slopes | 2.97 | 4.0% | | Ilw | 92 | 5.3 | 4.1 | 168 | 88 | 5.5 | 51 | 52 | 89 |
| 27A | Dickinson loam, 0 to 2 percent slopes | 2.81 | 3.8% | | Ills | 60 | 4 | 3.1 | 110 | 78 | | 33 | 47 | 46 |
| 1382 | Louris silt loam, 1 to 3 percent slopes | 2.46 | 3.3% | | I | 90 | 5.6 | 4.3 | 165 | 87 | | 50 | 52 | 88 |
| 1369A | Crooksford silt loam, 1 to 3 percent slopes | 1.07 | 1.5% | | I | 100 | 6.3 | 4.8 | 183 | 91 | | 55 | 55 | 78 |
| 156 | Fairhaven silt loam, 0 to 2 percent slopes | 0.45 | 0.6% | | Ills | 78 | 5.6 | 4.3 | 143 | 88 | | 43 | 53 | 59 |
| Weighted Average | | | | | | 74.6 | 3.3 | 2.6 | 104.8 | 58.6 | 1.2 | 31.6 | 35.3 | *n 65.7 |

*n: The aggregation method is "Weighted Average using all components"

*c: Using Capabilities Class Dominant Condition Aggregation Method

Soils data provided by USDA and NRCS.